



WCS59-20A-24V

I_p=20A



产品特点 Products Features

- 安装方便
Easy mounting
- 体积小, 节省空间
Small size and space saving
- 无插入损耗
No insertion losses
- 抗干扰能力强
High immunity to external interference

应用领域 Applications

- 交流变速驱动器
AC variable speed drives
- 直流电机驱动静态转换器
Static converters for DC motor drives
- 通讯电源
Battery supplied applications
- 不间断电源 (UPS)
Uninterruptible Power Supplies
- 开关电源 (SMPS)
SWITCHED Mode Power Supplies
- 电焊机
Power supplies for welding applications

机械尺寸 Mechanical dimension

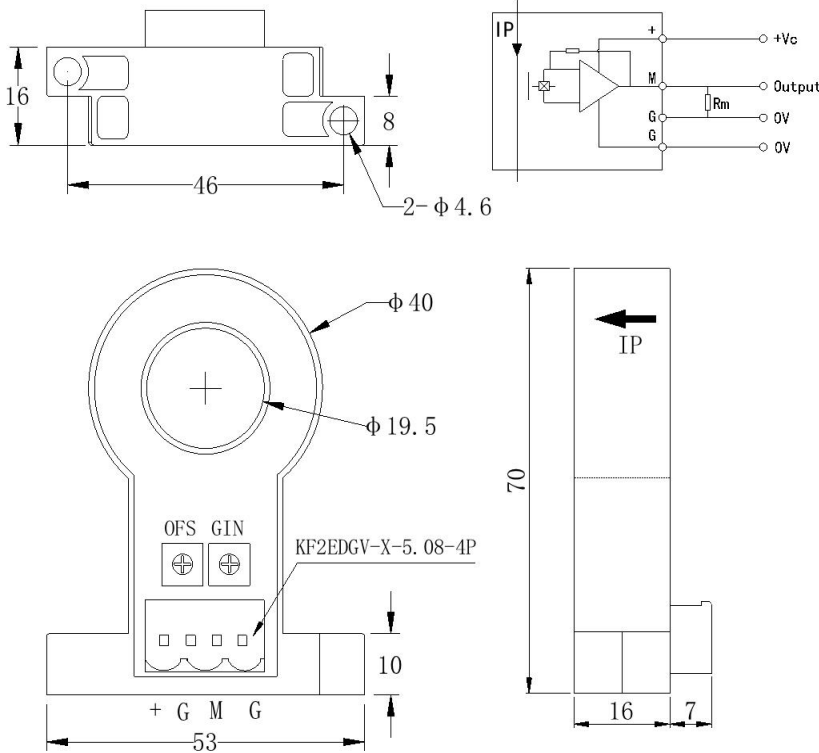

机械特性

Mechanical characteristics

一般公差
General tolerance
± 0.5 mm

其它公差执行
Other tolerance execution
GB/T 1804-2000-M

固定孔尺寸
Fixing hole size
Φ 4.5mm

紧固螺丝
Fastening steel screw
M4

建议紧固扭矩
Recommended fastening torque
2.0Nm (± 10 %)

连接器
Connection of secondary
KF2EDGCV-X5.08-4P

注意 Remarks

- 错误的接线可能导致传感器损坏。
The false wiring may result in the damage of the sensor.
- I_p方向与产品箭头方向一致时, 输出电压为正极。
V_{OUT} is positive when I_p flows in the direction of the arrow.
- 当初级导体完全充满初级孔径时动态表现 (di/dt和响应时间) 为最佳效果。
Dynamic performances (di/dt and response time) are best with a single bar completely filling the primary hole.
- 初级导体的温度不应超过130°C。
Temperature of the primary conductor should not exceed 130° C.

电气参数Electrical data WCS59-20A-24V

除非另有说明，否则环境参数均为@ $T_A = 25^{\circ}\text{C}$, $R_L = 10\text{ k}\Omega$

| | |
|---|-------------------------------------|
| 型号 Type | WCS59-20A-24V |
| 额定测量电流 I_{PN} Rated input | 20A |
| 测量范围 I_{PM} Measure range | 22A |
| 额定输出电压 V_{OUT} Rated output voltage | 5V |
| 零点失调电压 V_0 Offset voltage | $\leq 25\text{mV}$ |
| 电源电压 V_C Supply voltage | +24VDC ($\pm 5\%$) |
| 负载电阻 R_M Load resistance | $\geq 10\text{K}\Omega$ |
| 线性度 ϵ_L Linearity | $\leq 0.5\%FS$ |
| 总体精度 X Overall accuracy | $\pm 1\%FS$ |
| 零点失调电压温漂 V_{OUT} Offset voltage drift | $\pm 0.5\text{mV}/^{\circ}\text{C}$ |
| 幅度电压温度漂移 V_{OUT} Amplitude voltage temperature drift | $\leq 0.06\%/^{\circ}\text{C}$ |
| 静态电流消耗 I_C Current consumption | $\leq 30\text{mA}$ |
| 响应时间 T_R Response time | $< 20\mu\text{s}$ |
| 频带宽度 BW Frequency bandwidth-3db | DC |
| di/dt 跟随精度 di/dt accurately followed | $> 2\text{A}/\mu\text{s}$ |
| 绝缘耐压 V_D Galvanic isolation | 50Hz, 1min, 3KV |
| 工作环境温度 T_A Ambient operating temperature | $-40\sim+85^{\circ}\text{C}$ |
| 储存环境温度 T_s Ambient storage temperature | $-40\sim+95^{\circ}\text{C}$ |
| 质量 m Mass | $\approx 62\text{g}$ |
| 执行标准 Standards | JB/T 7490-2007 |

定制Customized

这是一个标准的产品，需要其他规格（测量电流、电源电压、输出电压、连接器、转换比率等）请联系我们。
This is a standard model. For different versions (IP, supply voltages, output voltages, connection of secondary, turns ratios...), please contact us.

联系方式Contact information

李伟军 18576410868 www.gchsensor.com victor801@vicorv.com